

# DUMPSQUEEN

## Microsoft Power Automate RPA Developer

Microsoft PL-500

Version Demo

Total Demo Questions: 10

Total Premium Questions: 113

Buy Premium PDF

<https://dumpsqueen.com>

[support@dumpsqueen.com](mailto:support@dumpsqueen.com)

dumpsqueen.com

## Topic Break Down

Topic	No. of Questions
Topic 1, Contoso Pharmaceuticals	8
Topic 2, City Power and Light	10
Topic 3, Mix Questions	95
<b>Total</b>	<b>113</b>

## QUESTION NO: 1 - (DRAG DROP)

You are developing automation solutions for a company. You need to use an environment variable in a cloud flow.

Which three actions should you perform in sequence? To answer, move the appropriate actions from the list of actions to the order.

**Actions**

- Add an environment variable to a solution.
- Create a cloud flow in a solution.
- Navigate to <https://flow.microsoft.com>.
- Navigate to <https://admin.powerplatform.com>.
- Select the desired environment variable.

**Answer Area**

## ANSWER:

**Actions**

- Add an environment variable to a solution.
- Create a cloud flow in a solution.
- Navigate to <https://flow.microsoft.com>.
- Navigate to <https://admin.powerplatform.com>.
- Select the desired environment variable.

**Answer Area**

- Create a cloud flow in a solution.
- Navigate to <https://admin.powerplatform.com>.
- Add an environment variable to a solution.

## QUESTION NO: 2 - (HOTSPOT)

You create an environment for a company. You need to configure security to meet the company's requirements and follow the principle of least privilege. Which security roles should you assign? To answer, select the appropriate options in the answer area.

NOTE: Each correct selection is worth one point.

Requirement	Security role
A user must be able to register new machines in the environment.	Environment Maker Desktop Flows Machine Owner
A user must be able to share their machine with another user.	Environment Maker Desktop Flows Machine User Desktop Flows Machine User Can Share
A user must be able to run desktop flows on a registered machine.	Environment Maker Desktop Flows Machine User Desktop Flows Machine User Can Share
A user must be able to create a machine group and add machines to the machine group.	Environment Maker Desktop Flows Machine User Desktop Flows Machine Owner

## ANSWER:

Requirement	Security role
A user must be able to register new machines in the environment.	Environment Maker Desktop Flows Machine Owner
A user must be able to share their machine with another user.	Environment Maker Desktop Flows Machine User Desktop Flows Machine User Can Share
A user must be able to run desktop flows on a registered machine.	Environment Maker Desktop Flows Machine User Desktop Flows Machine User Can Share
A user must be able to create a machine group and add machines to the machine group.	Environment Maker Desktop Flows Machine User Desktop Flows Machine Owner

## Explanation:

## Answer Area

Requirement	Security role
A user must be able to register new machines in the environment.	<ul style="list-style-type: none"><li>Environment Maker</li><li>Desktop Flows Machine Owner</li></ul>
A user must be able to share their machine with another user.	<ul style="list-style-type: none"><li>Environment Maker</li><li>Desktop Flows Machine User</li><li>Desktop Flows Machine User Can Share</li></ul>
A user must be able to run desktop flows on a registered machine.	<ul style="list-style-type: none"><li>Environment Maker</li><li>Desktop Flows Machine User</li><li>Desktop Flows Machine User Can Share</li></ul>
A user must be able to create a machine group and add machines to the machine group.	<ul style="list-style-type: none"><li>Environment Maker</li><li>Desktop Flows Machine User</li><li>Desktop Flows Machine Owner</li></ul>

### QUESTION NO: 3

You are creating a cloud flow that will use two Update Row actions to interact with Microsoft Dataverse. Neither of these actions are dependent on each other. You must minimize the amount of processing time required to complete the flow. You need to implement the actions in the cloud flow.

Solution: Create a do until loop.

Does the solution meet the goal?

- A. Yes
- B. No

**ANSWER: A**

### QUESTION NO: 4

You are creating a cloud flow that will use two Update Row actions to interact with Microsoft Dataverse. Neither of these actions are dependent on each other. You must minimize the amount of processing time required to complete the flow. You need to implement the actions in the cloud flow.

Solution: Create two sequential Update Row actions.

Does the solution meet the goal?

- A. Yes

B. No

**ANSWER: B**

**QUESTION NO: 5**

You need to resolve the issue with the DataCollector flow.

What are two possible ways to achieve the goal? Each correct answer presents a complete solution.

NOTE: Each correct selection is worth one point

- A. Add an If web page contains action to determine whether a field exists and write data only when true.
- B. Configure the Populate text field on a web page actions to continue running the flow in case of error.
- C. Replace the Populate text field on a web page action with the Send keys action to write data.
- D. Remove the Focus text field on a web page actions that precede actions which write data to text fields.
- E. Modify selectors to ensure that field attributes are mapped correctly.

**ANSWER: A E**

**QUESTION NO: 6 - (HOTSPOT)**

You create a solution that includes a Power Automate cloud flow and desktop flow. You observe the following issues with the solution:

- A single Power Automate cloud flow action has a long run time.
- The Power Automate desktop flow encounters an error.

You need to debug the solution.

Which debug features should you use? To answer, select the appropriate options in the answer area.

**Answer Area**

Issue	Debug feature
Long run time for a single cloud flow action.	<input type="checkbox"/> Timeout <input type="checkbox"/> Retry policy <input checked="" type="checkbox"/> Timeout <input type="checkbox"/> Run from here <input type="checkbox"/> Breakpoints
Most recent error in the desktop flow.	<input checked="" type="checkbox"/> Get last error <input type="checkbox"/> Breakpoints <input type="checkbox"/> Run subflow <input type="checkbox"/> On block error <input checked="" type="checkbox"/> Get last error

**ANSWER:**



**Explanation:**



## QUESTION NO: 7

You need to configure permissions for the Purchase order quantity flow. Which permission should you assign?

- A. Co-owner
- B. Run-only user
- C. Owner
- D. User

**ANSWER: B**

**Explanation:**

To configure permissions for the Purchase order quantity flow, you should assign the run-only user permission to the finance clerk. This will allow them to run the flow without being able to edit or share it<sup>1</sup>. The other permissions are not suitable for this scenario because:

## QUESTION NO: 8

You develop a desktop flow. The flow performs five actions in sequence.

If an error occurs, you must restart the flow from the first action. You add the five actions to an On block error action.

You need to configure error handling.

Which two actions should you perform? Each correct answer presents part of the solution.

NOTE: Each correct selection is worth one point.

- A. Change the exception handling mode to Go to the beginning of the block.
- B. Select Continue flow run.
- C. Select Throw error.
- D. Change the exception handling mode to Go to next action.
- E. Configure an On error condition for the first action.

**ANSWER: A B**

## QUESTION NO: 9 - (DRAG DROP)

You create a solution within a Microsoft Power Platform environment. The environment includes all connections required for the solution.

You need to create a connection reference for the flows.

Which four actions should you perform in sequence? To answer, move the appropriate actions from the list of actions to the answer area and arrange them in the order.

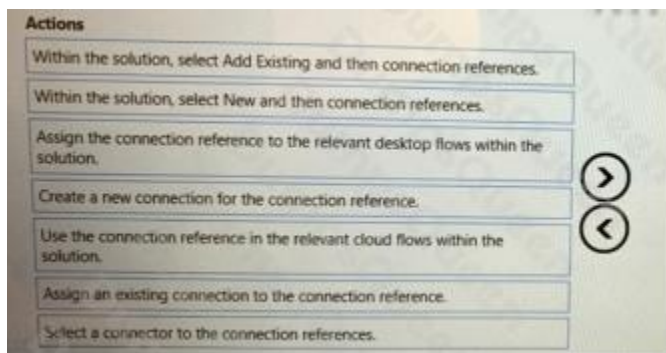

**ANSWER:**



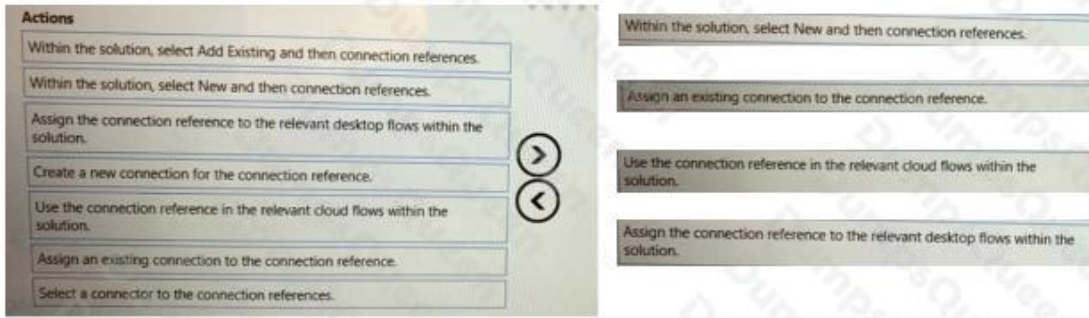

### Explanation:

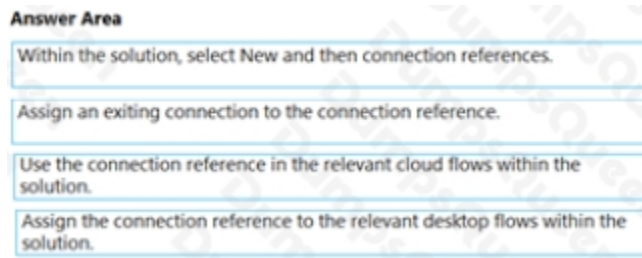

### QUESTION NO: 10

You need to resolve the issue reported with the RailStatusUpdater flow.

What are two possible ways to achieve the goal? Each correct answer presents a complete solution.

NOTE: Each correct selection is worth one point.

- A. Put the desktop flow action into a Do until loop. Run until the desktop flow is successful.
- B. Call a separate child cloud flow to perform the desktop flow a second time.
- C. Create a duplicate action for the desktop flow and configure the duplicate action to run if the first desktop flow action fails.
- D. Create a duplicate action for the desktop flow to run after the first desktop flow.

**ANSWER: A C**